

EXISTING IMPERVIOUS COVER  
WITHIN 150' SETBACKS

**UDG**  
Urban Design Group PC  
TX Registered Engineering Firm #11443  
3660 Stoneridge Road  
Suite E101  
Austin, TX 78746  
512.347.0040

**T B G**  
Landscape Architects Planners  
1705 Guadalupe Street, Suite 500  
Austin, Texas 78701  
(512) 327-5111 Fax: (512) 327-0488  
Austin Dallas Houston San Antonio

AUSTIN OAKS PUD  
DEMONSTRATIVE EXHIBIT  
CEF ANALYSIS

EXISTING IMPERVIOUS COVER WITHIN SETBACK = 86,376 S.F. = 1.98 AC.

SHEET  
1 OF 2

JULY 12, 2016

UDG JOB NO. 15-864

1"=40'

AUSTIN OAKS 15-864

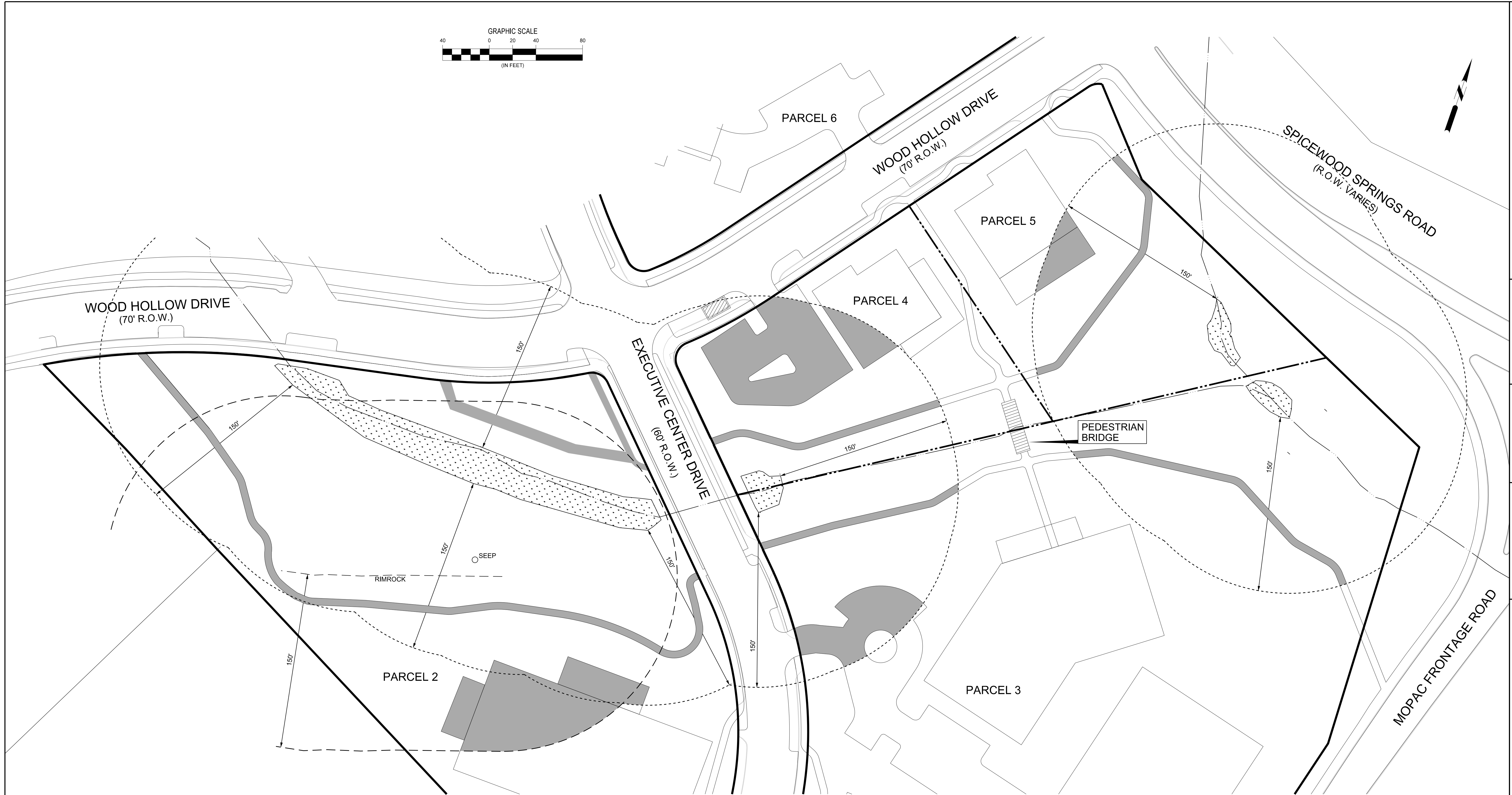
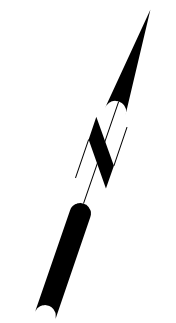
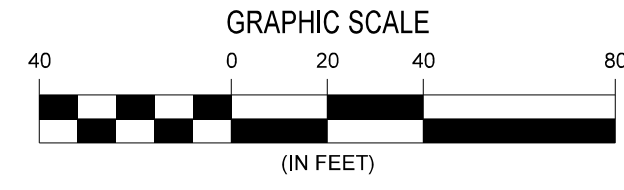

PROPOSED IMPERVIOUS COVER  
WITHIN 150' SETBACKS

**UDG**  
Urban Design Group PC  
TX Registered Engineering Firm #11443  
3660 Stoneridge Road  
Suite E101  
Austin, TX 78746  
512.347.0040

**T B G**  
Landscape Architects Planners  
1705 Guadalupe Street, Suite 500  
Austin, Texas 78701  
(512) 327-5111 Fax: (512) 327-0488  
Austin Dallas Houston San Antonio

AUSTIN OAKS PUD  
DEMONSTRATIVE EXHIBIT  
CEF ANALYSIS

PROPOSED IMPERVIOUS COVER WITHIN SETBACK = 41,400 S.F. = APPROXIMATELY 0.95 AC.

SHEET  
2 OF 2

JULY 12, 2016

UDG JOB NO. 15-864

1"=40'

AUSTIN OAKS 15-864